

# NEMA 4 Rated ODE

## Wallmount Enclosures

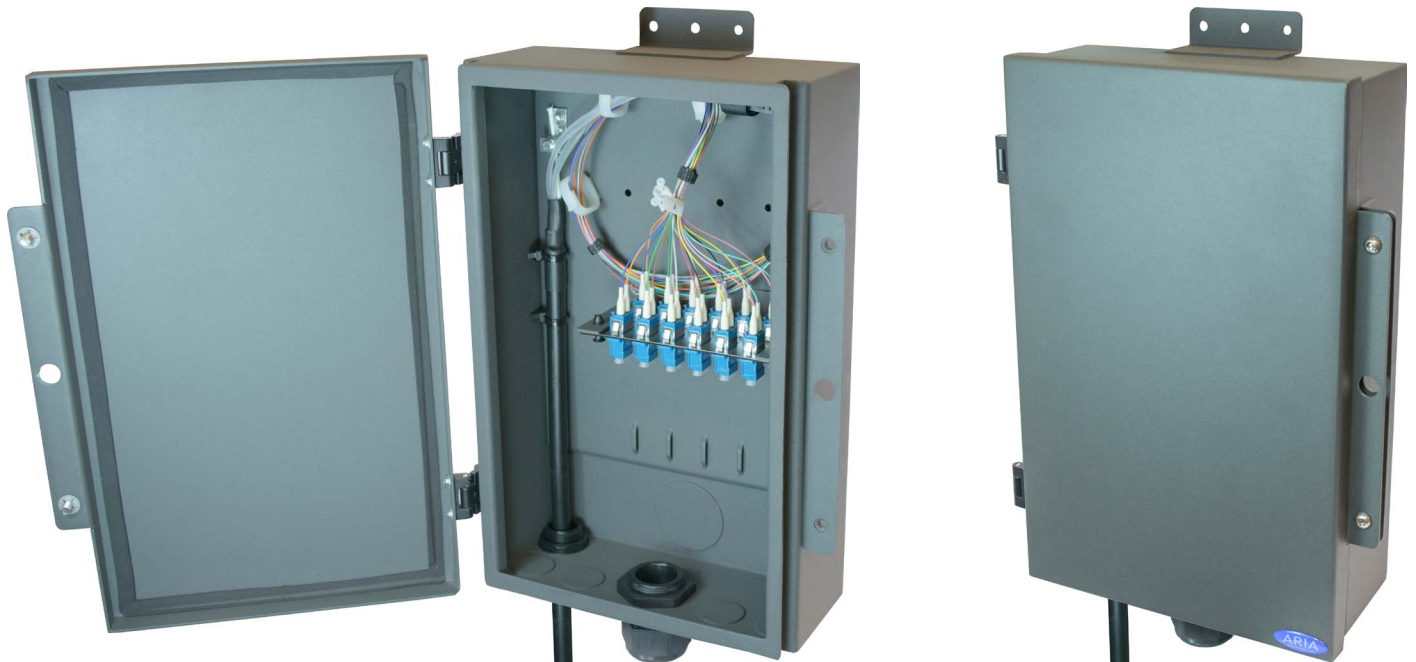

### Overview

ARIA NEMA 4 Rated Outdoor Enclosure (ODE) Wallmount Enclosures are designed for environments where durability, security, and weather resistance are required.

The ODE can be supplied with a microduct manifold, pre-terminated drop cable, or ODVA adapters.

The compact and rugged format provides an ideal pole mountable enclosure for many applications.

### NEMA 4 Rated

Rated for either indoor or outdoor use and provides protection to personnel against incidental contact with the enclosed equipment and protects from falling dirt, rain, sleet, snow, windblown dust, splashing water, hose-directed water and the external formation of ice.



### Features

- Lightweight, weatherproof, and flexible enclosure provides connectivity in almost any environment.
- The bottom of the ODE features knockouts that support compression fittings or adapters for ODVA Style IP67 Rated Cable Assemblies.
- There is a knockout on the rear of the ODE that accepts an optional weatherproof gasket for securely transitioning cable to the inside of a pole.
- The outer pad-lockable door and wallmount brackets can be supplied with Torx Security fasteners for enhanced security.
- Pole mount brackets are available
- Microduct manifold support provides the ability to accept air blown or pushable fiber.
- Cable tie down locations and fiber management rings provide an organized and secure path for fiber.



### Specifications

<b>Dimensions (Inches)</b>	15.3 x 9.5 x 4.3 (HxWxD)
<b>Adapter Plate Capacity</b>	2
<b>Fiber Capacity</b>	24 SC or 48 LC
<b>Bottom Knockouts</b>	(6) 1.1" and (1) 1.5"
<b>Rear Knockouts</b>	(1) 2.0" Knockout
<b>Material</b>	2.0mm Thick Aluminum
<b>Material Finish</b>	Gray Powder Coat
<b>Weight (Empty) (lbs)</b>	5.0
<b>Additional Features</b>	Knockout on rear for cable entry via pole

### Bottom Cable Entry

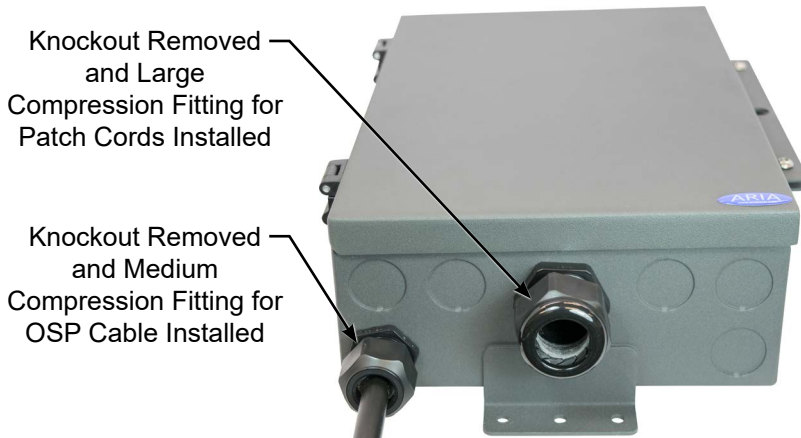

### Rear Cable Entry

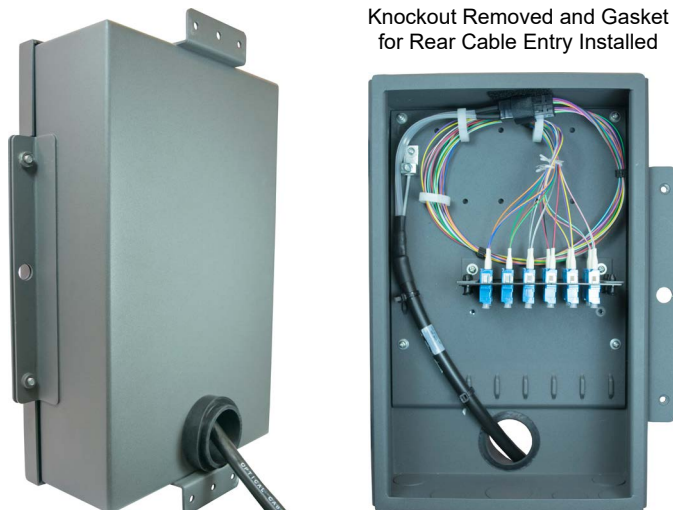

### Microduct Manifold Support



# NEMA 4 Rated ODE Wallmount Enclosures

## Compatible with ODVA IP67 Rated Cable Assemblies



The bottom side of the enclosure features knockouts that are compatible with ODVA Style IP67 Rated Cable Assemblies



### Accessories



Medium Compression Fitting Supports  
Cable O.D.: 0.25"-0.49" P/N: CF-MD



Three Slot Flat Drop Compression Fitting with Rem. Spacers  
P/N: CF-3S-FD



Large Compression Fitting Supports Cable O.D.: 0.59"-0.99" P/N: CF-LG



\*Not Compatible with Pole Mount Brackets

Gasket for Rear Cable Entry using a 10" Pole\* (P/N: ODE-REAR-GASKET)



Side Cable Attachment Bracket  
P/N: ODE-SCAB

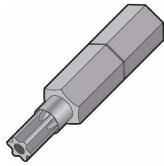

Torx Security Bit  
P/N: TS-M6-B



Torx Security Driver with Bit  
P/N: TS-M6-D



Tap for Direct Pole Mounting  
P/N: M6-1-TAP



Pole Mount Brackets  
P/N: PMB-KIT



15" Diameter Pole Mount Straps (P/N: PMB-STRAPS)



Compression Fitting Strain Relief Bracket  
P/N: CMPFITSR-BRACKET



Microduct Manifold Supports 10 mm OD Microduct  
P/N: MDM-12X-10



Microduct Manifold Supports 8.5 mm OD Microduct  
P/N: MDM-12X-8.5

### Part Number



**1** Enclosure Fasteners  
 P2 = Phillips Drive for lid and wallmounting  
 T2 = Torx Security Drive for lid and wallmounting  
 T6 = Torx Security Drive for lid and metal pole mounting

**2** Adapter Plate Type  
 00 = None  
 06 = 6 Port (SC/FC/ST)  
 08 = 8 Port (SC/FC/ST)  
 12 = 12 Port (SC/LC/FC/ST)  
 24 = 24 Port (LC)

**3** Adapter Plate Quantity  
 X = X Plates

**4** Adapter Type  
 SC = SC  
 LC = LC  
 FC = FC  
 ST = ST  
 00 = None

**4** Polish Type  
 U = Singlemode UPC  
 A = Singlemode APC\*  
 M = Multimode UPC  
 0 = None  
 \*Unavailable for ST

**5** Fiber Type  
 Leave Blank for No Stub  
 S = SM 9/125µm G.652.D  
 B = SM 9/125µm Bend Insensitive G.657.A1  
 1 = MM 62.5/125µm OM1  
 2 = MM 50/125µm OM2  
 3 = MM 50/125µm OM3  
 4 = MM 50/125µm OM4

**6** Stub Cable Construction  
 Leave Blank for No Stub  
 D = Distribution (I or X)  
 B = Breakout (X)  
 M = Micro Round (I, X, or O)  
 L = Loose Tube (X or O)  
 R = Ribbon (I, X, or O)  
 F = Flat Drop (Up to 24F) (O)  
 (I) = Indoor Only  
 (X) = Indoor/Outdoor Only  
 (O) = Outdoor Only

**7** Stub Jacket Type  
 Leave Blank for No Stub  
 Choose 1 Option for Each Feature:  
 I = Indoor or X = I/O or O = Outdoor  
 R = OFNR or P = OFNP or L = LSZH\*  
 N = Non-Armored or A = Armored\*  
 \*Leave Blank for Outdoor Cable

**8** Stub Length  
 Leave Blank for No Stub  
 Add -PE for a Pulling Eye  
 Add -R for rear cable exit  
 XXXF = XXX Feet  
 XXXM = XXX Meters